

Critical Wear Areas & Vacuum Test Locations

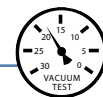

NOTE: OE valves are shown in rest position and should be tested in rest position unless otherwise indicated. Test locations are pointed to with an arrow. Springs are not shown for visual clarity. Low vacuum reading indicates wear and Sonnax parts are noted for replacement.

JF016E Lower Valve Body

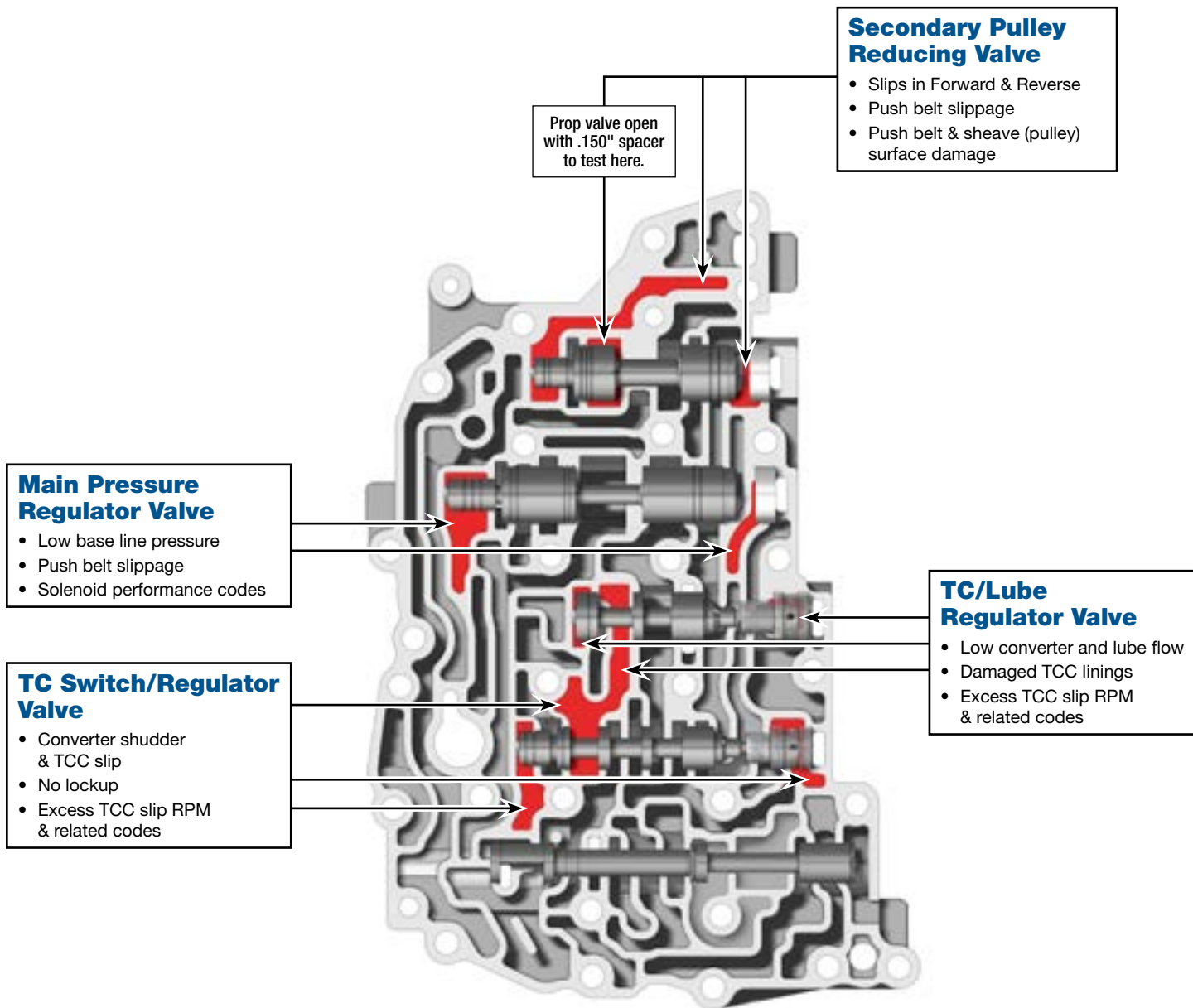

Critical Wear Areas & Vacuum Test Locations

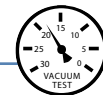

NOTE: OE valves are shown in rest position and should be tested in rest position unless otherwise indicated. Test locations are pointed to with an arrow. Springs are not shown for visual clarity. Low vacuum reading indicates wear and Sonnax parts are noted for replacement.

JF016E Upper Valve Body

Primary Pulley Reducing Valve

- No high ratios
- High or low primary pulley pressure
- Solenoid performance codes

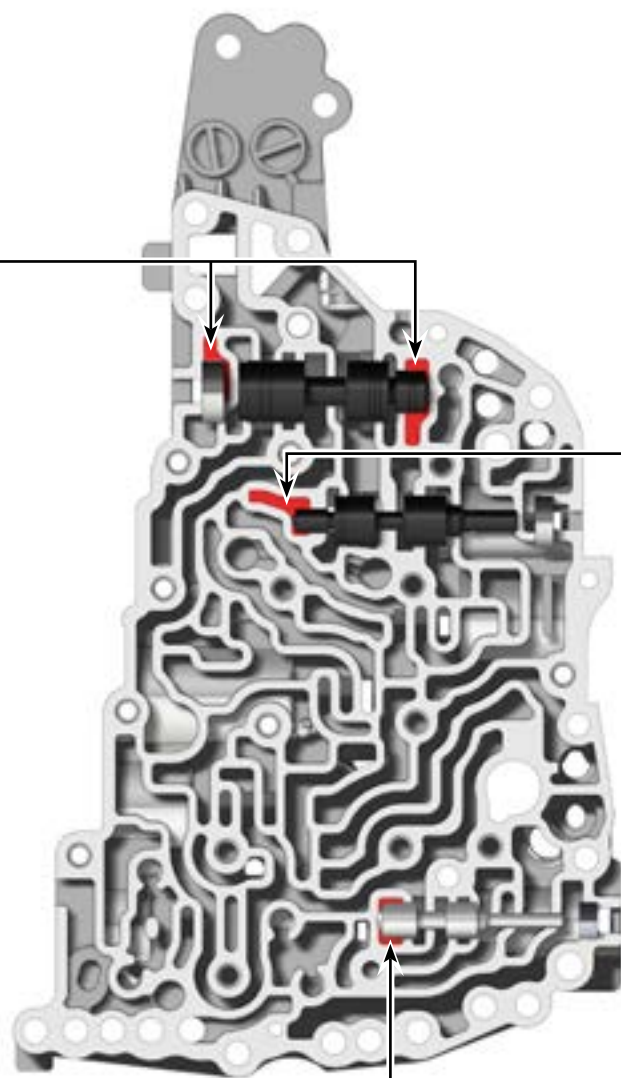

Pilot Valve A

- Low solenoid feed pressure
- Solenoid performance codes

Pilot Valve B

- Low solenoid feed pressure
- TCC slip codes

OE Exploded View

JF016E Lower Valve Body

NOTE: Depending upon vehicle application, the OE springs shown may not be present.

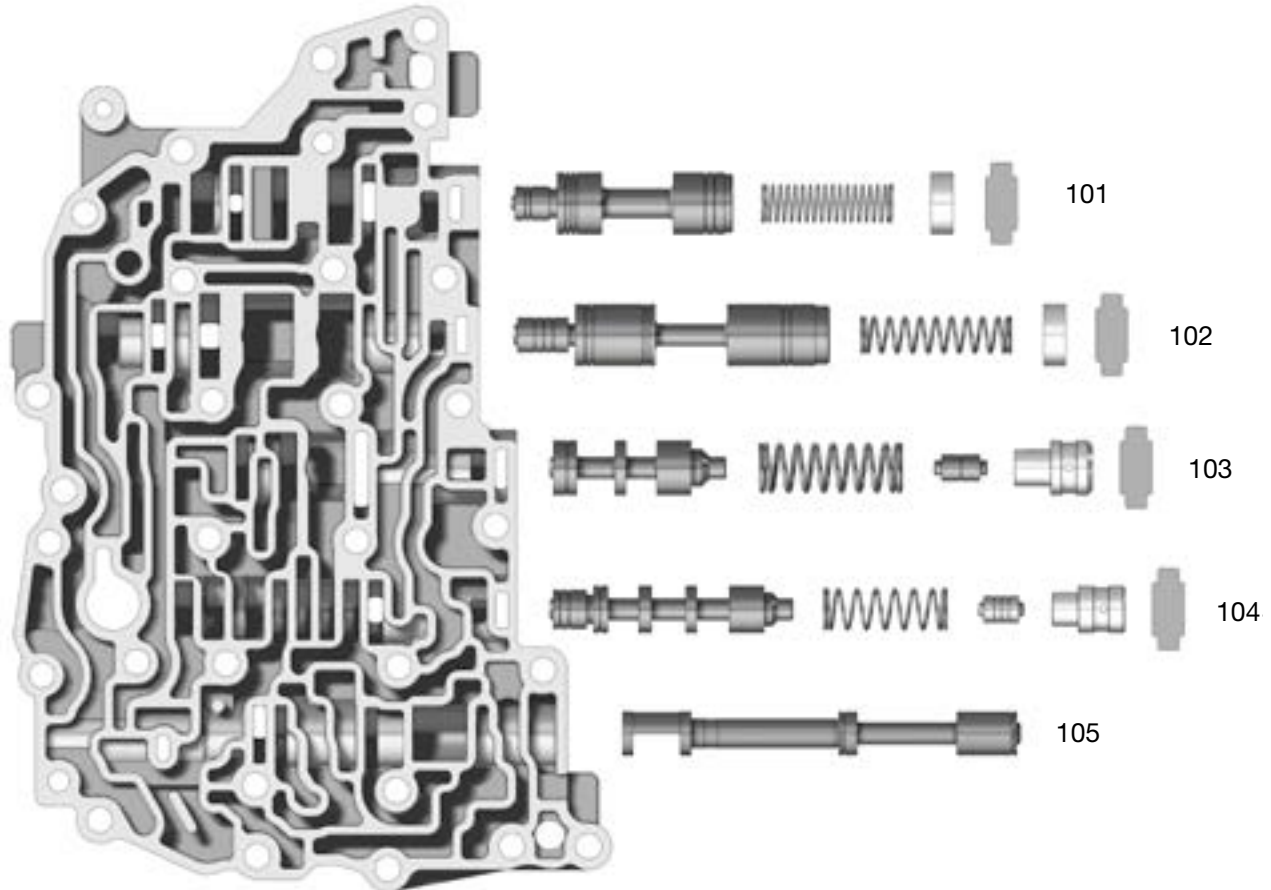

JF016E, JF017E Valve Body Descriptions

I.D. No.	Description
101	Secondary Pulley Reducing Valve
102	Main Pressure Regulator Valve
103	TC/Lube Regulator Valve
104	TC Switch/Regulator Valve
105	Manual Valve

OE Exploded View

JF016E Upper Valve Body

NOTE: Depending upon vehicle application, the OE springs shown may not be present.

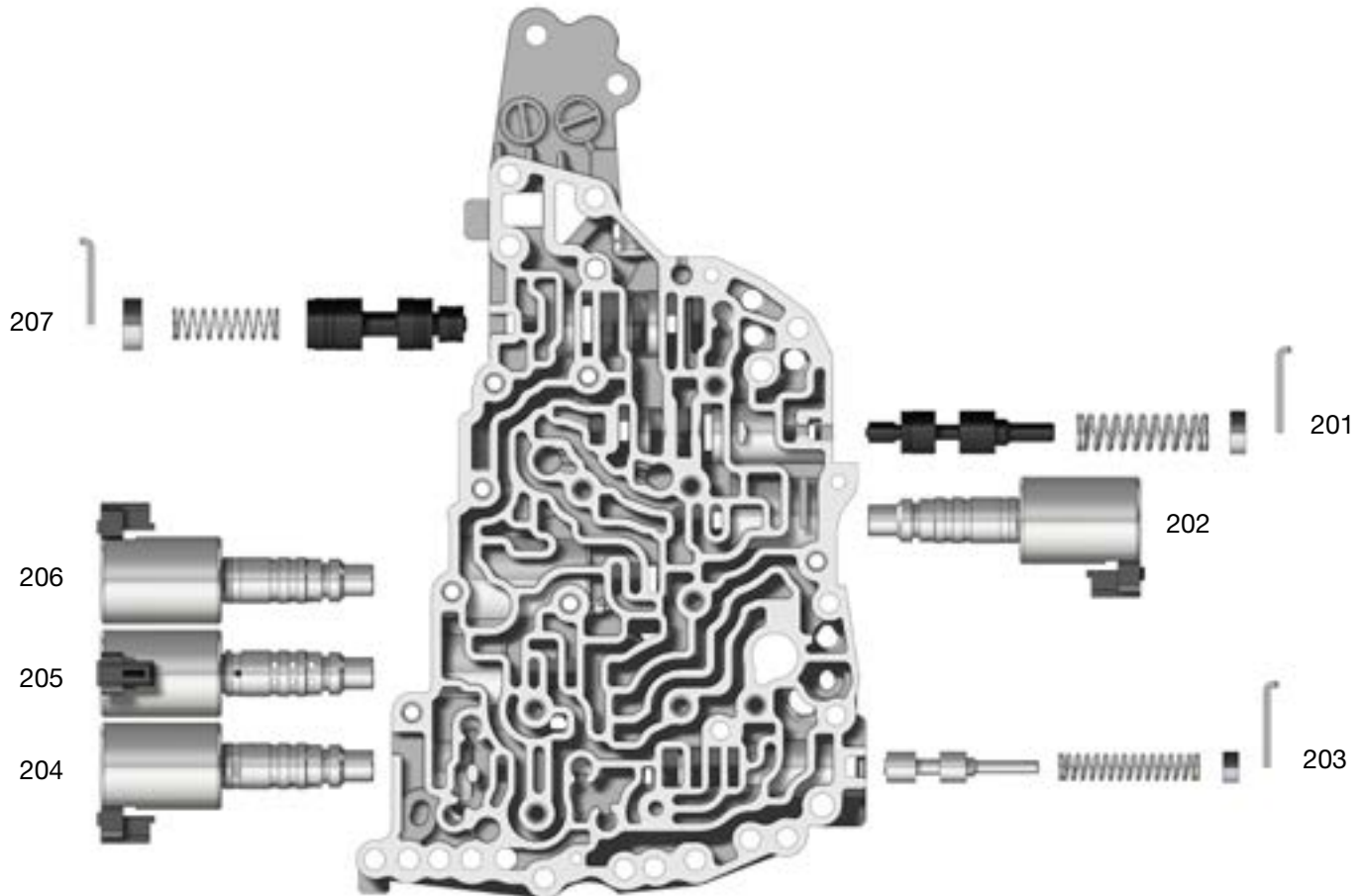

JF016E, JF017E Valve Body Descriptions

I.D. No.	Description
201	Pilot Valve A
202	Primary Pulley Solenoid Valve
203	Pilot Valve B
204	Select Solenoid Valve
205	Line Pressure Solenoid Valve
206	Secondary Pulley Solenoid Valve
207	Primary Pulley Reducing Valve