

HONDA 4-SPEED 1996-05 A4RA, B4RA, BDRA, BMXA, M4RA, S24A, S4RA, SLXA.

BMXA SLXA TRANSMISSION CUTAWAY

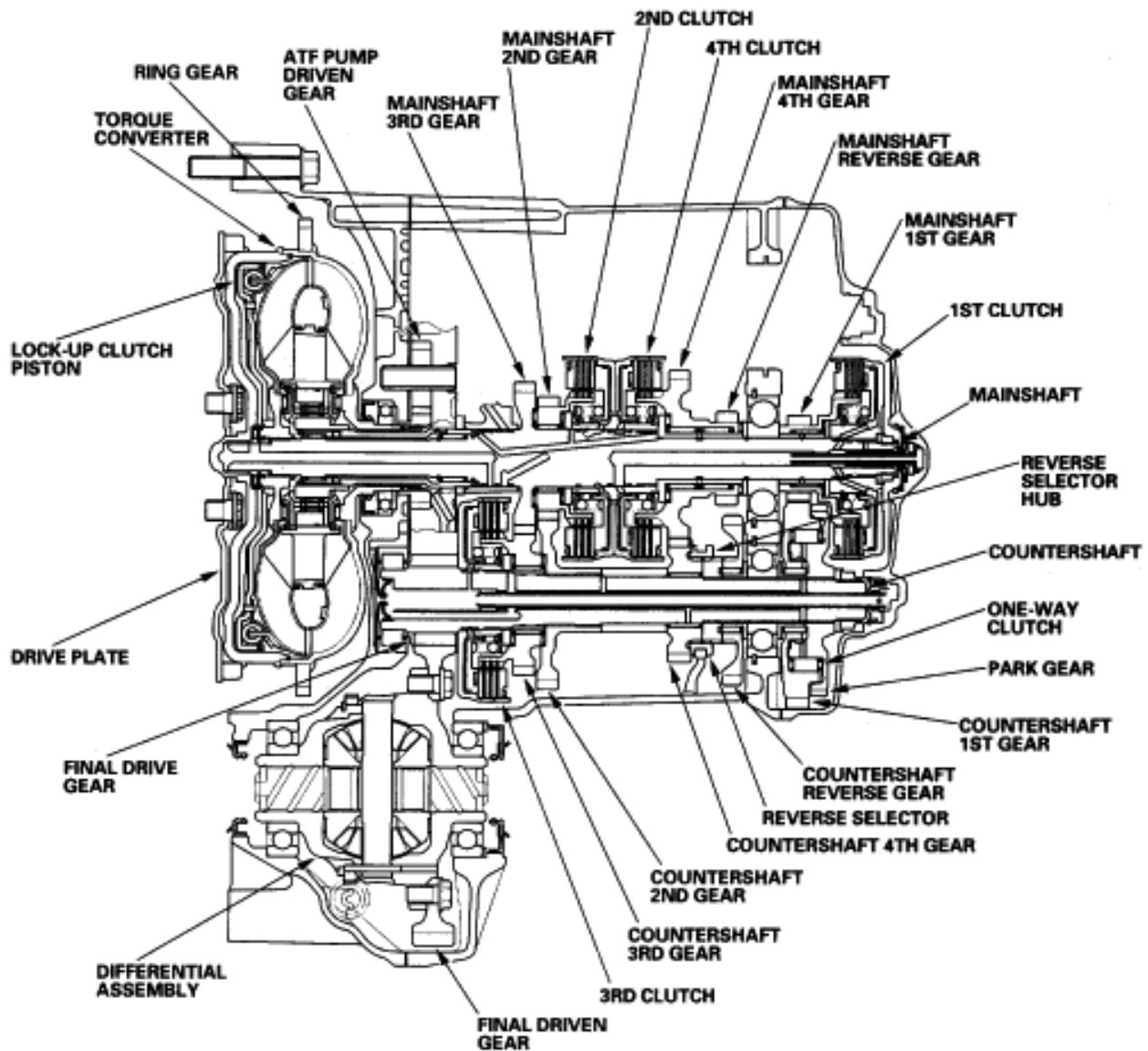

A4RA B4RA BDRA M4RA S4RA TRANSMISSION CUTAWAY

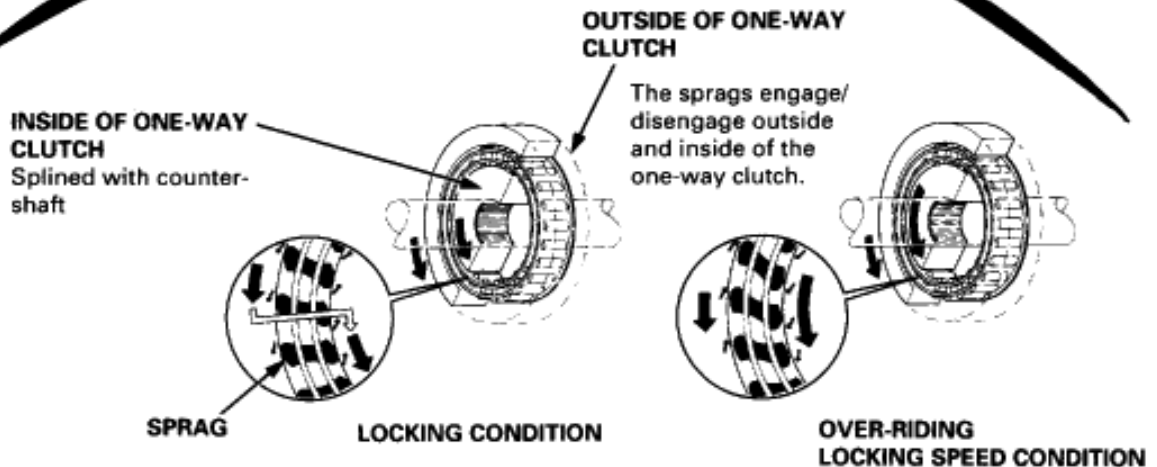
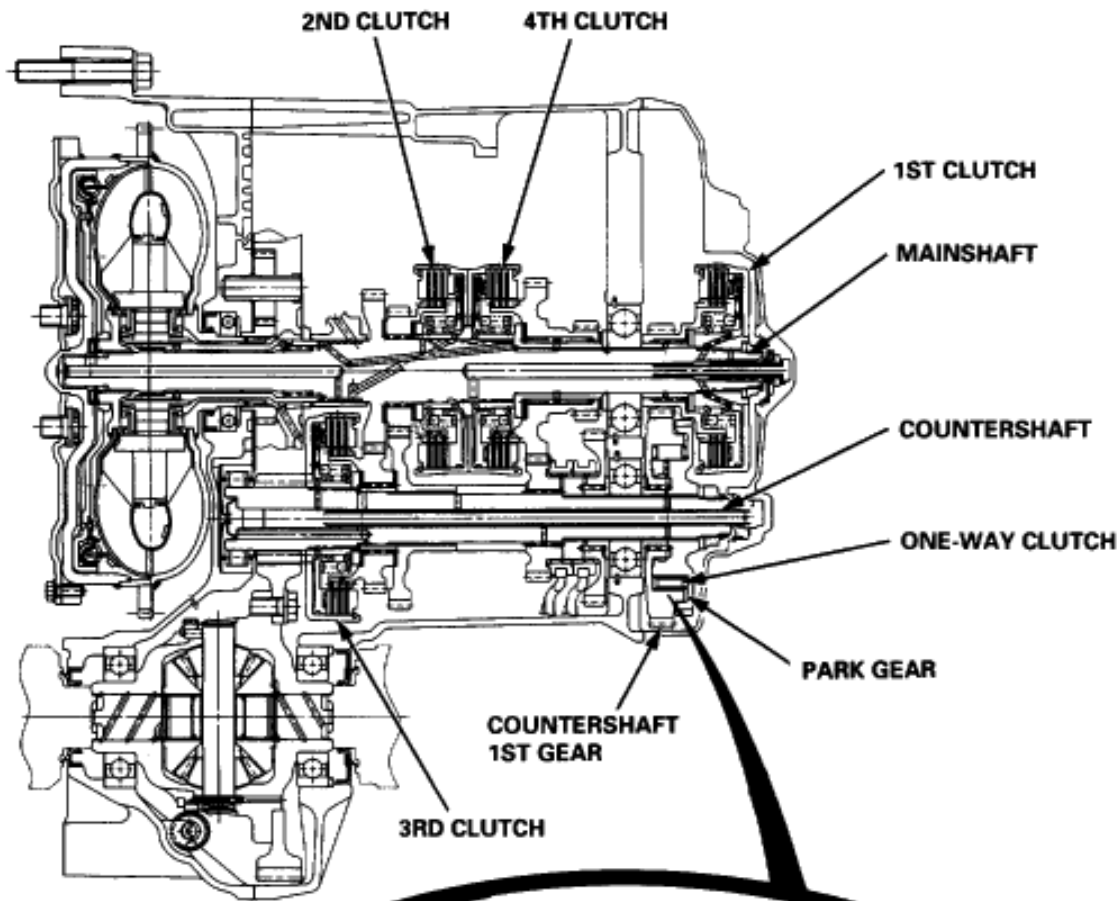

S24A TRANSMISSION CUTAWAY

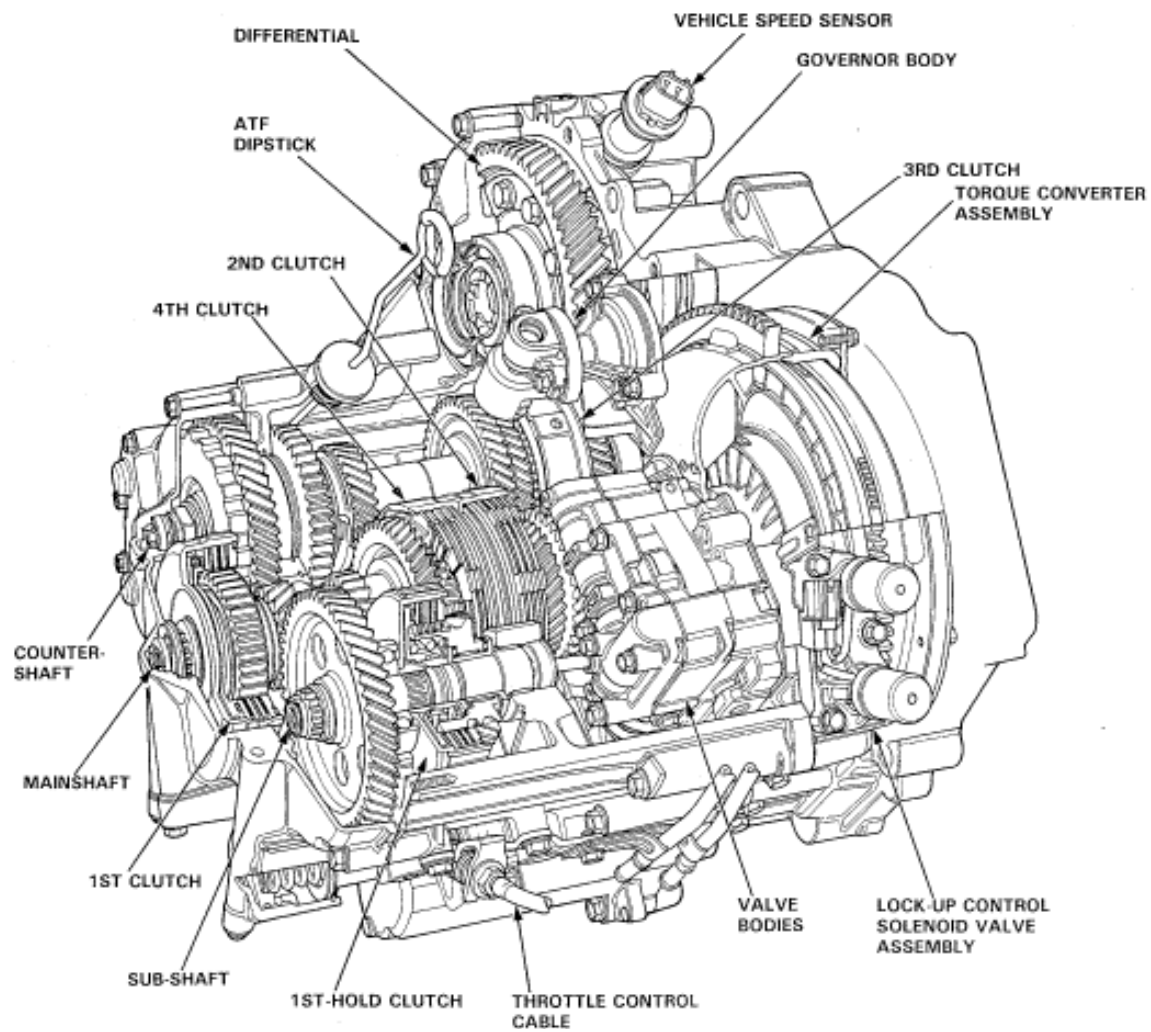

MAINSHAFT

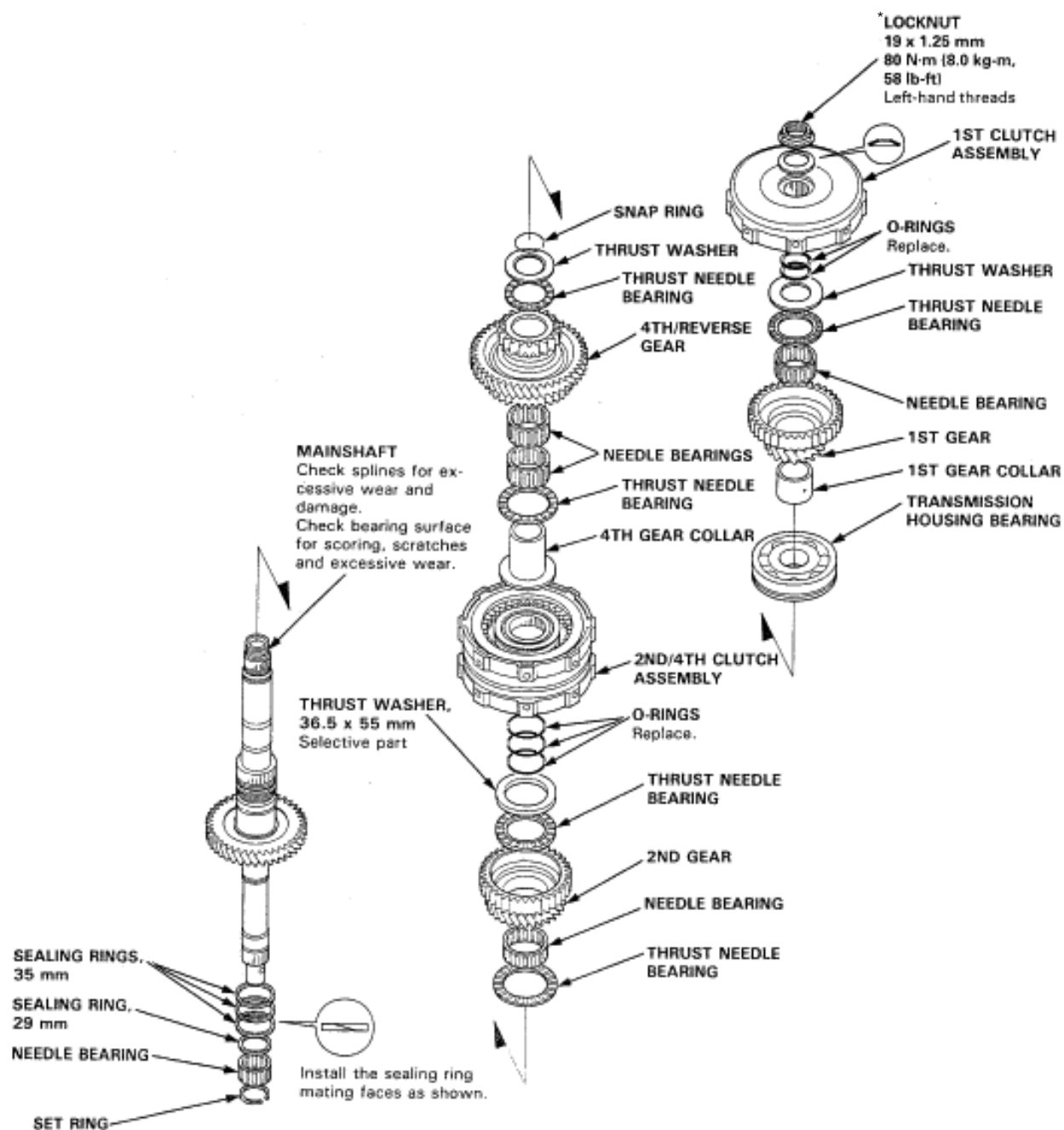

* A4RA, B4RA, BDRA, M4RA, S4RA, BMXA, SLXA Locknut is 21 x 1.25 mm (78 N-m)

COUNTERSHAFT

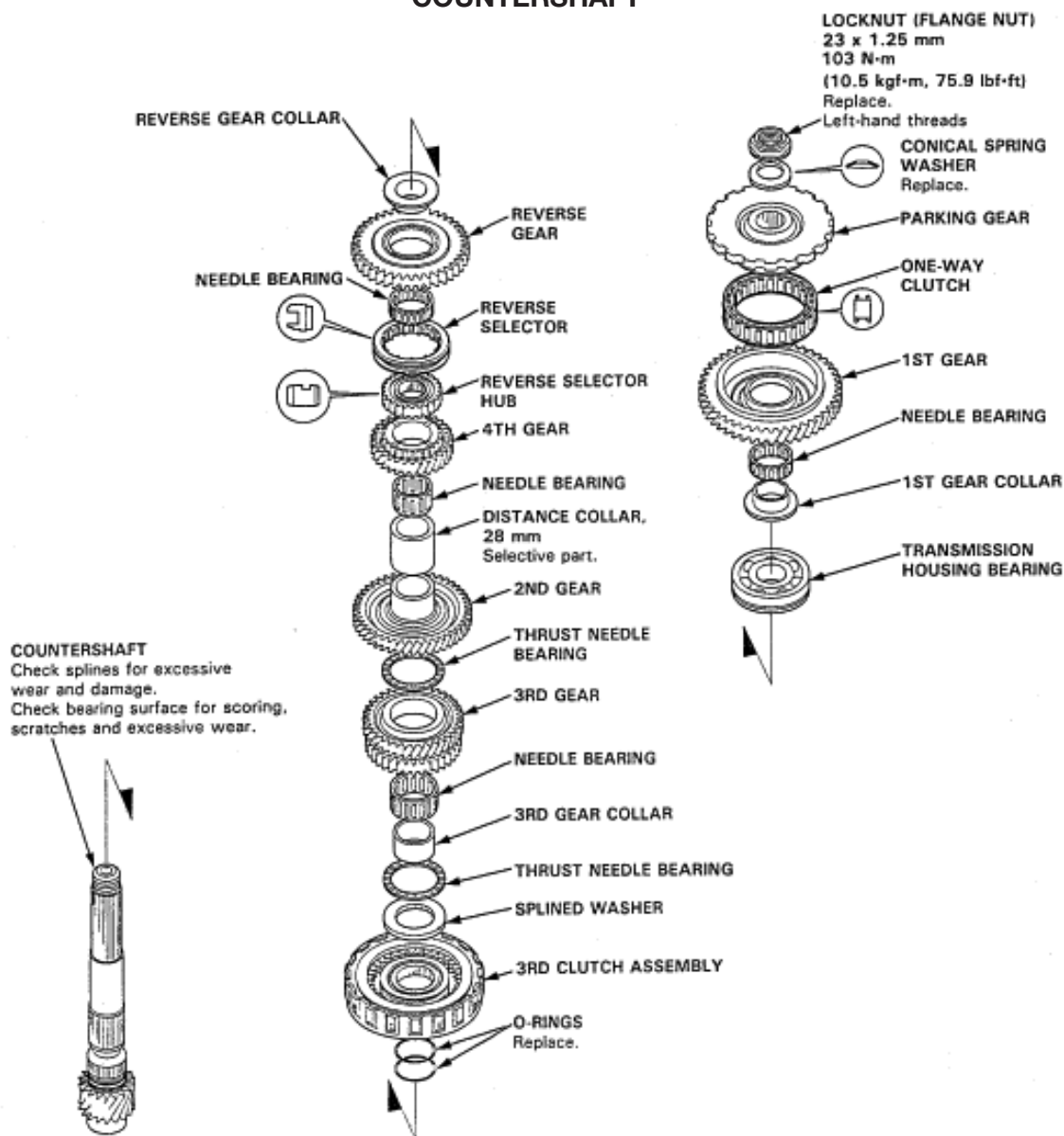

Clutch Clearance

A4RA, B4RA, BDRA, M4RA, S4RA, BMXA, SLXA, S24A

Clutch	Standard
1st Clutch, 2nd Clutch	0.65-0.85 (0.026-0.033)
3rd Clutch, 4th Clutch	0.40-0.60 (0.016-0.024)
1st Hold Clutch (S24A Only)	0.50-0.80 (0.020-0.031)

Stall Speed A4RA, B4RA, BDRA, M4RA, S4RA

Standard	Service Limit
2,700 rpm	2,560-2,850 rpm

Stall Speed BMXA, SLXA

Engine	Standard	Service Limit
D17A2	2,830 rpm	2,680-2,980 rpm
D17A1	2,780 rpm	2,630-2,930 rpm

Stall Speed S24A

Standard	Service Limit
2,700 rpm	2,500 – 2,900 rpm

A4RA, B4RA, BDRA, M4RA, S4RA, S24A SHIFT CONTROL

Position	Gear	Shift Control Solenoid Valve A	Shift Control Solenoid Valve B
D₄ , D₃	1st	OFF	ON
	2nd	ON	ON
	3rd	ON	OFF
D₄	4th	OFF	OFF
2	2nd	ON	ON
R	Reverse	ON	OFF

A4RA, B4RA, BDRA, M4RA, S4RA, S24A LOCKUP

Lock-up Conditions	Lock-up Control Solenoid Valve A	Lock-up Control Solenoid Valve B	Linear Solenoid Pressure
Lock-up OFF	OFF	OFF	High
Lock-up, Half	ON	Duty operation OFF ↔ ON	Low
Lock-up, Full	ON	ON	High
Lock-up during deceleration	ON	Duty operation OFF ↔ ON	Low

BMXA, SLXA SHIFT CONTROL

Position	Gear	Shift Control Solenoid Valve A	Shift Control Solenoid Valve B
D and D₃	1st	OFF	ON
	2nd	ON	ON
	3rd	ON	OFF
D	4th	OFF	OFF
2	2nd	ON	ON
R	Reverse	ON	OFF
	Reverse Inhibit	OFF	ON
N	---	OFF	OFF
P	---	OFF	OFF

A4RA, B4RA, BDRA, M4RA, S4RA MAIN VALVE BODY

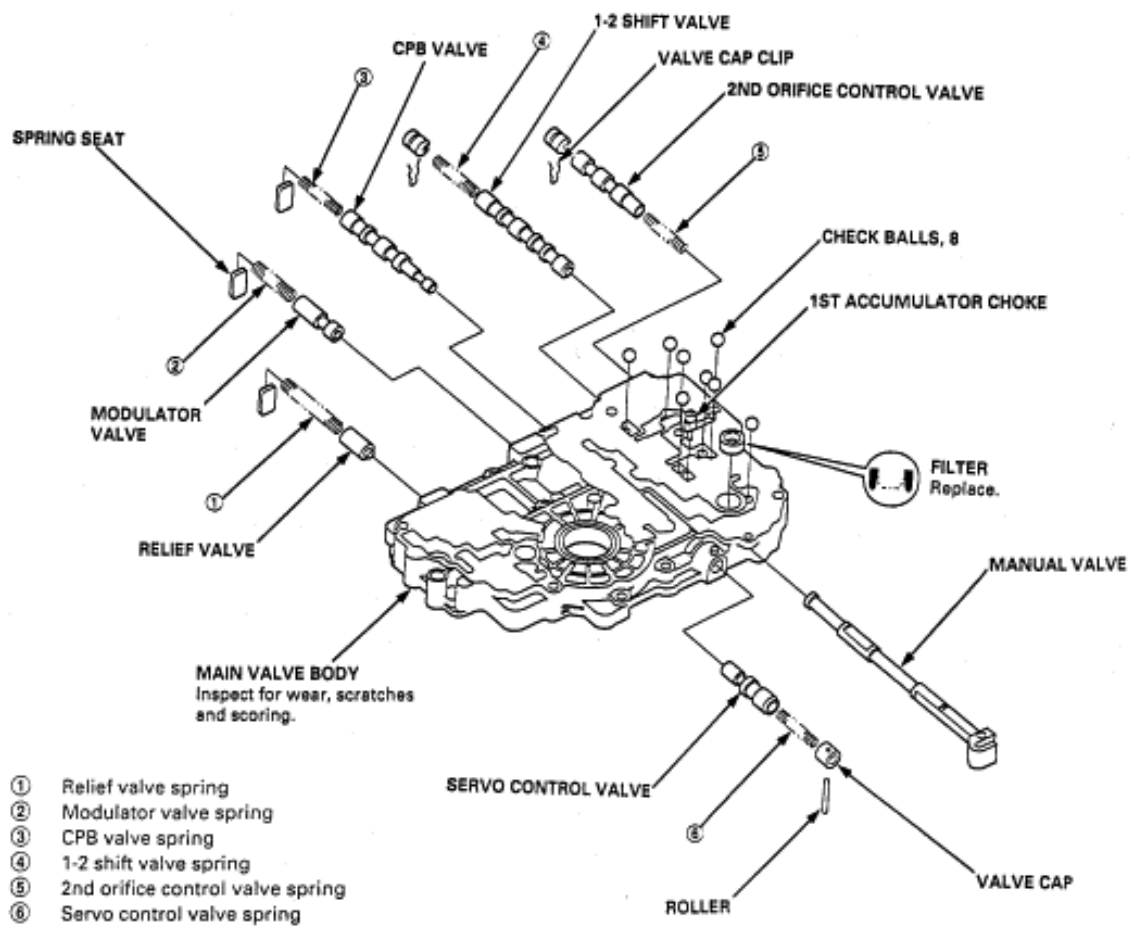

BMXA, SLXA MAIN VALVE BODY

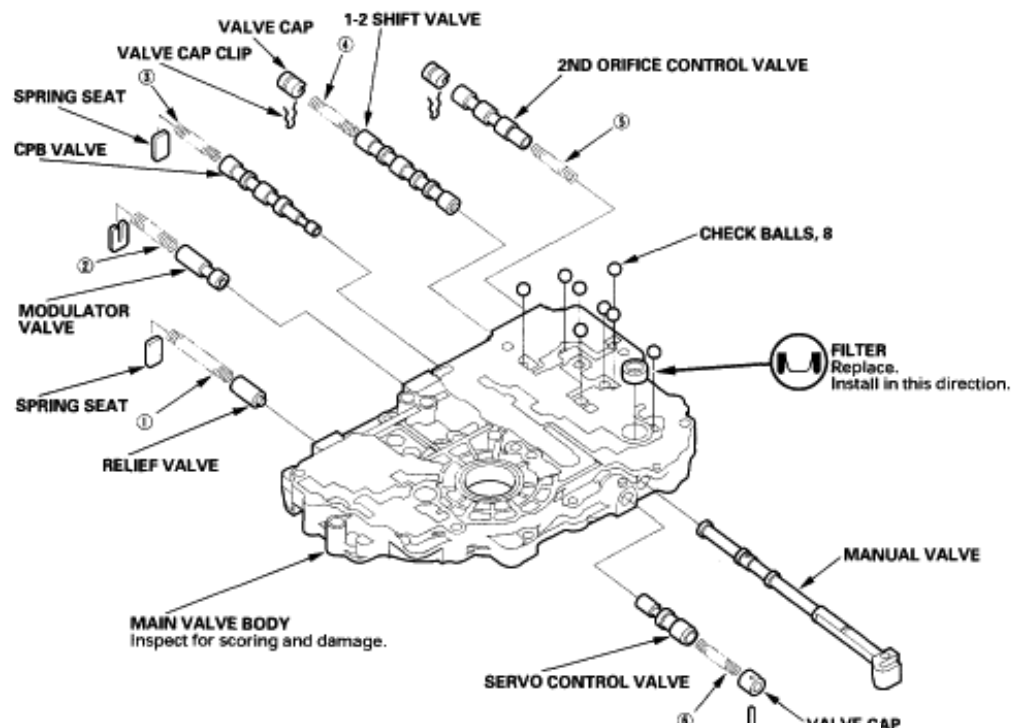

S24A MAIN VALVE BODY

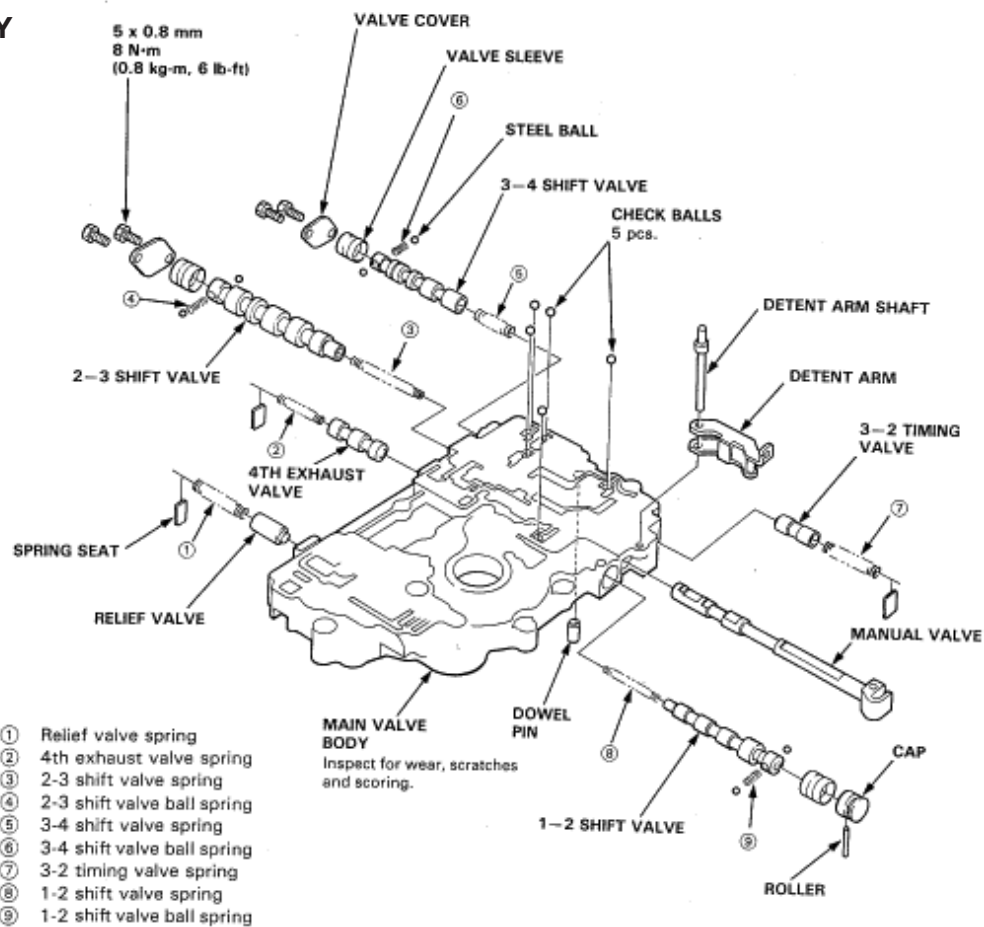

A4RA, B4RA, BDRA, M4RA, S4RA SECONDARY VALVE BODY

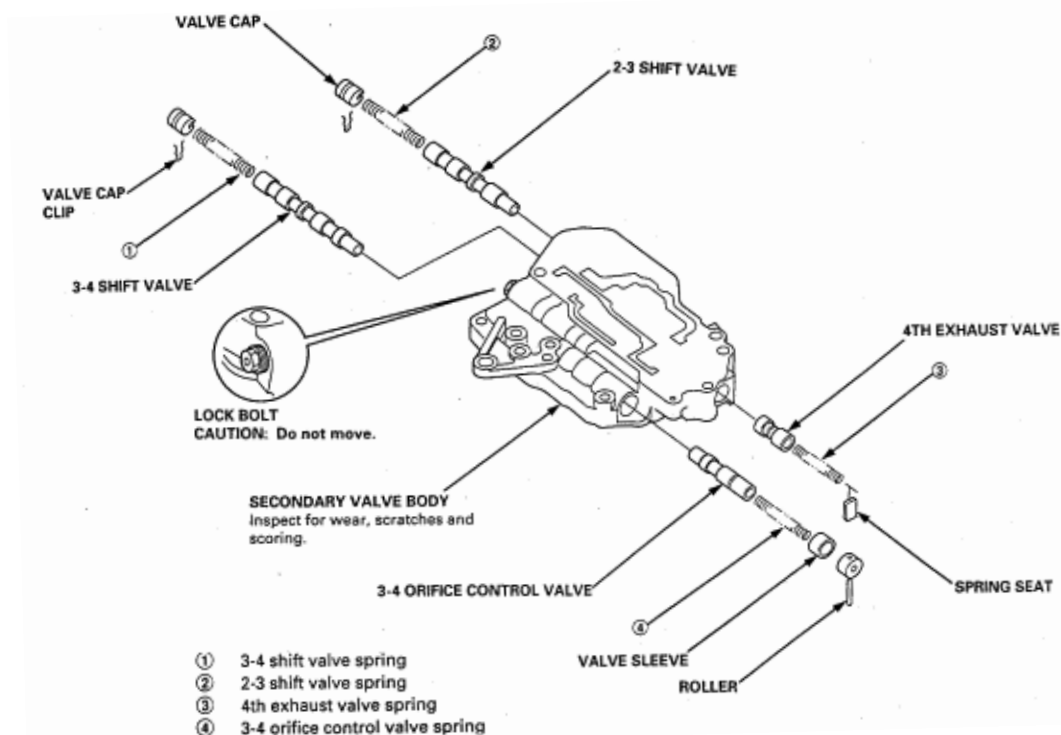

BMXA, SLXA SECONDARY VALVE BODY

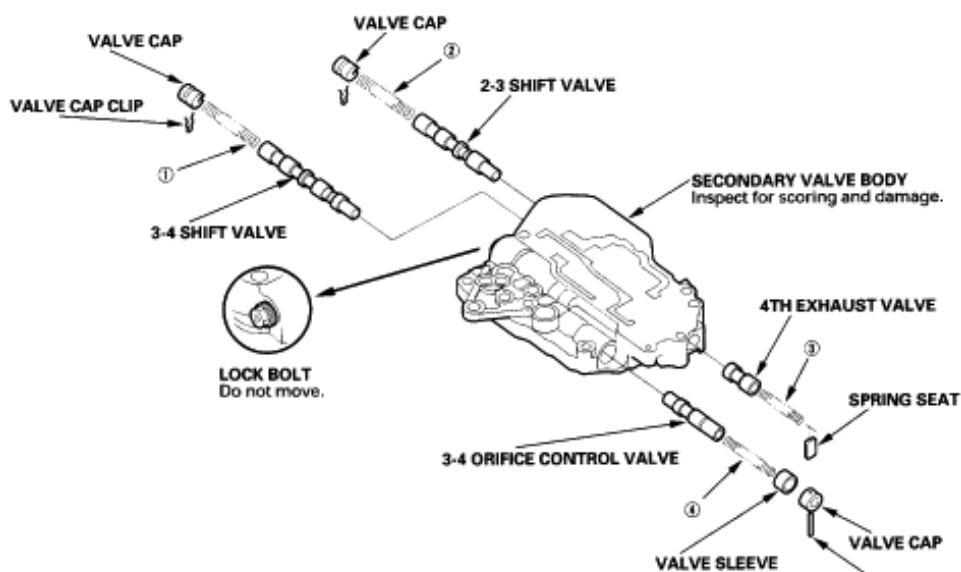

SPRING SPECIFICATIONS

No.	Spring	Standard (New)-Unit: mm (in.)			
		Wire Dia.	O.D.	Free Length	No. of Coils
①	3-4 shift valve spring	0.9 (0.035)	7.6 (0.299)	57.0 (2.244)	26.8
②	2-3 shift valve spring	0.9 (0.035)	7.6 (0.299)	57.0 (2.244)	26.8
③	4th exhaust valve spring	0.9 (0.035)	6.1 (0.240)	36.4 (1.433)	19.5
④	3-4 orifice control valve spring	0.7 (0.028)	6.6 (0.260)	37.5 (1.476)	24.6

S24A SECONDARY VALVE BODY

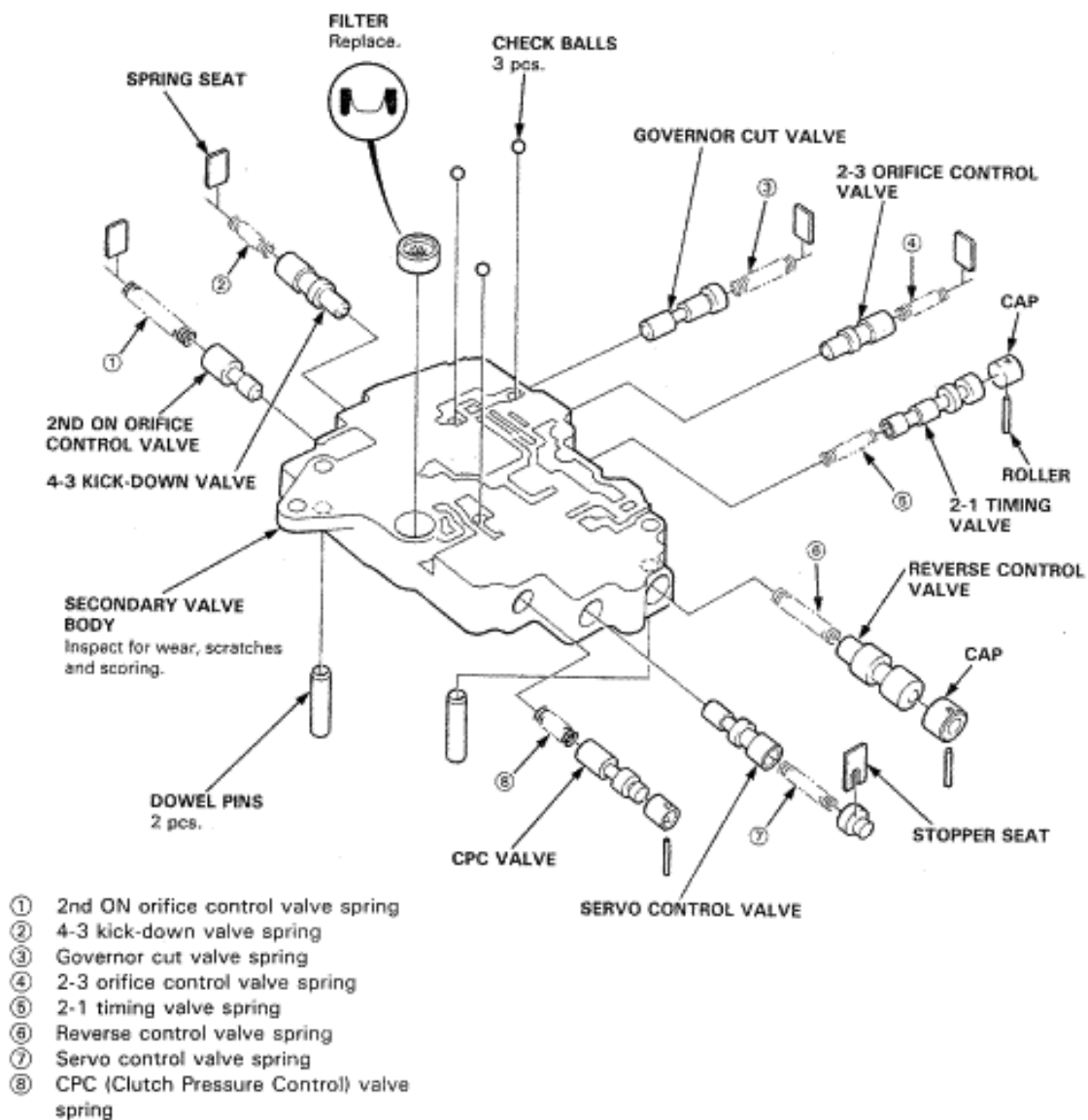

A4RA, B4RA, BDRA, M4RA, S4RA REGULATOR VALVE BODY

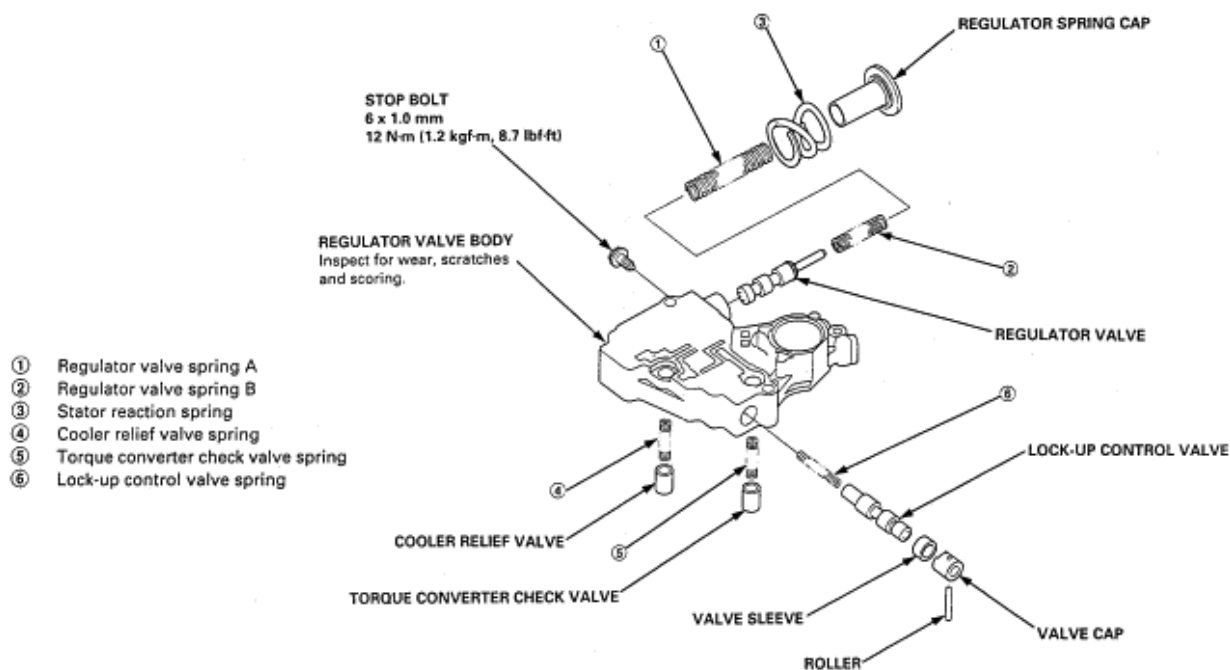

BMXA, SLXA REGULATOR VALVE BODY

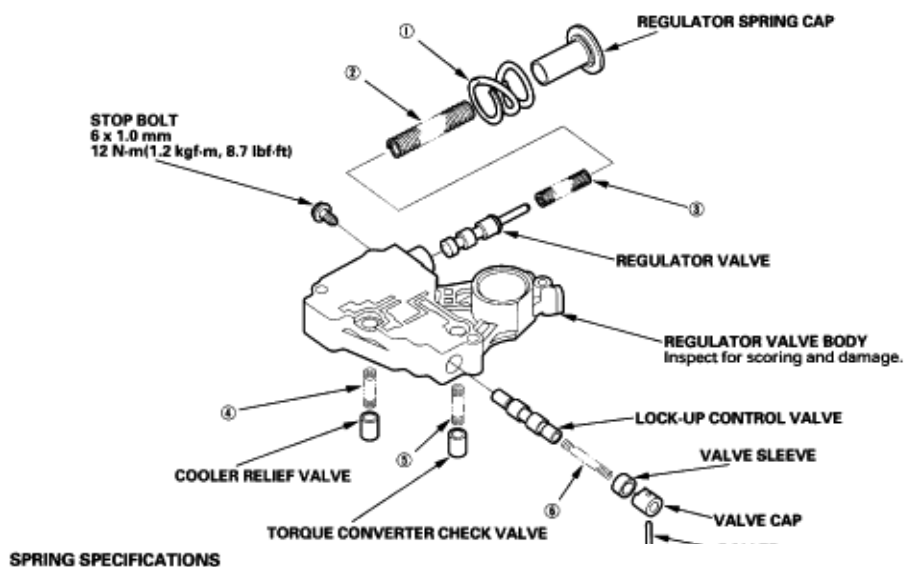

SPRING SPECIFICATIONS

No.	Spring	Standard (New)-Unit: mm (in.)			
		Wire Dia.	O.D.	Free Length	No. of Coils
①	Stator reaction spring	4.5 (0.177)	35.4 (1.394)	30.3 (1.193)	1.9
②	Regulator valve spring A	1.9 (0.075)	14.7 (0.579)	77.4 (3.047)	15.2
③	Regulator valve spring B	1.8 (0.071)	9.6 (0.378)	44.0 (1.732)	12.6
④	Cooler relief valve spring	1.0 (0.039)	8.4 (0.331)	33.8 (1.331)	8.2
⑤	Torque converter check valve spring	1.0 (0.039)	8.4 (0.331)	33.8 (1.331)	8.2
⑥	Lock-up control valve spring	0.8 (0.031)	6.0 (0.236)	38.4 (1.512)	30.3

S24A REGULATOR VALVE BODY

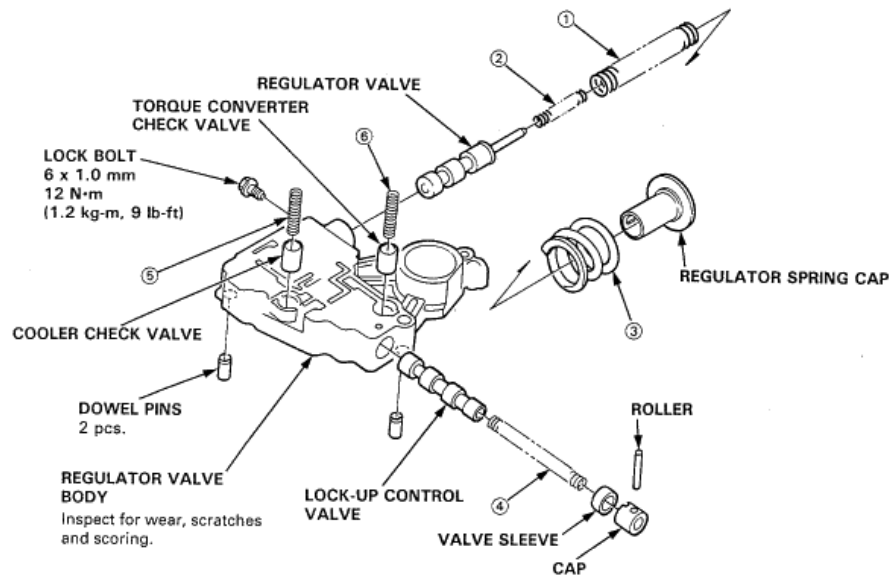

- ① Regulator valve spring A
- ② Regulator valve spring B
- ③ Stator reaction spring
- ④ Lock-up control valve spring
- ⑤ Cooler check valve spring
- ⑥ Torque converter check valve spring

A4RA, B4RA, BDRA, M4RA, S4RA SERVO

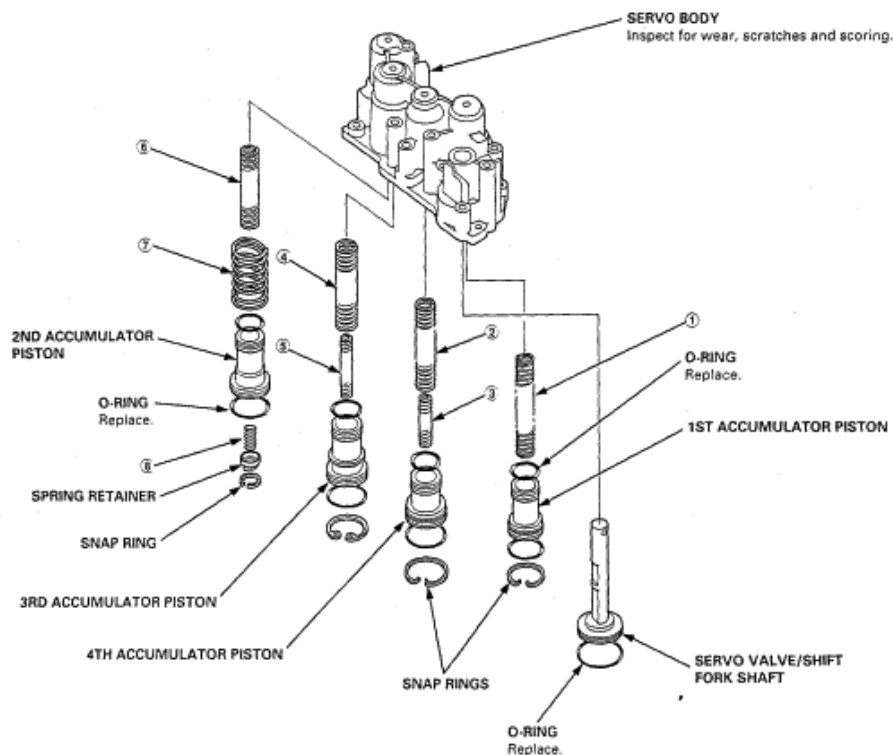

- ① 1st accumulator spring
- ② 4th accumulator spring A
- ③ 4th accumulator spring B
- ④ 3rd accumulator spring A
- ⑤ 3rd accumulator spring B
- ⑥ 2nd accumulator spring C
- ⑦ 2nd accumulator spring A
- ⑧ 2nd accumulator spring B

BMXA, SLXA SERVO

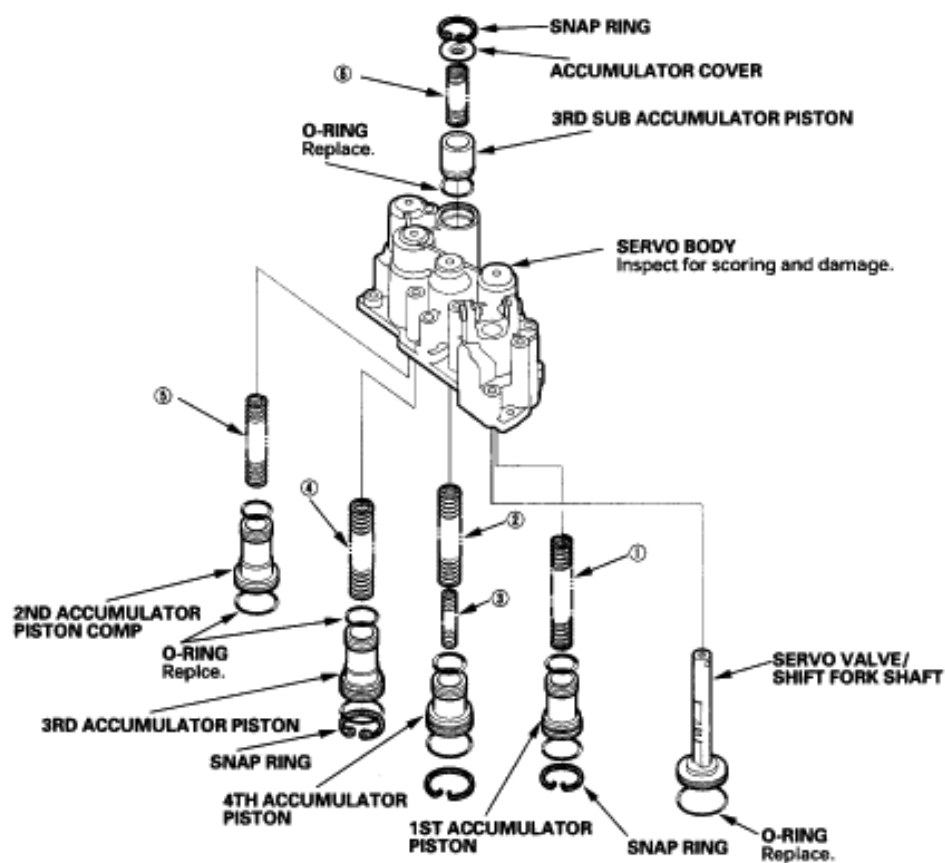

SPRING SPECIFICATIONS

No.	Spring	Standard (New)-Unit: mm (in.)			
		Wire Dia.	O.D.	Free Length	No. of Coils
①	1st accumulator spring	2.1 (0.083)	16.0 (0.630)	89.1 (3.508)	16.2
②	4th accumulator spring A	2.6 (0.102)	17.0 (0.669)	88.4 (3.480)	14.2
③	4th accumulator spring B	2.3 (0.091)	10.2 (0.402)	51.6 (2.031)	13.8
④	3rd accumulator spring	2.9 (0.110)	17.5 (0.689)	89.2 (3.713)	13.4
⑤	2nd accumulator spring A	2.4 (0.087)	14.5 (0.571)	68.0 (2.677)	12.5
⑥	3rd sub accumulator spring	2.7 (0.106)	17.0 (0.669)	39.0 (1.535)	6.3

S24A SERVO

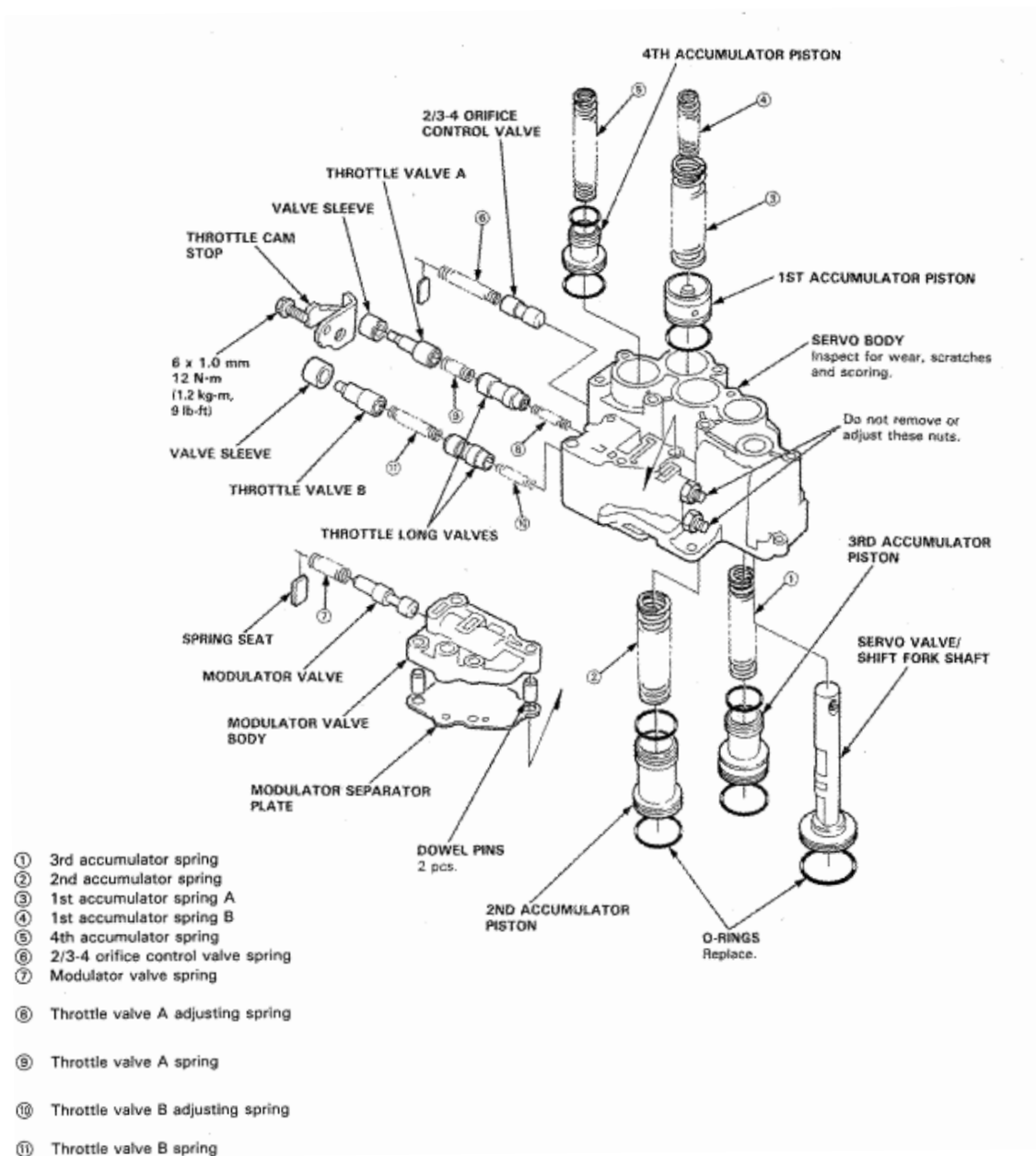

A4RA, B4RA, BDRA, M4RA, S4RA LOCKUP

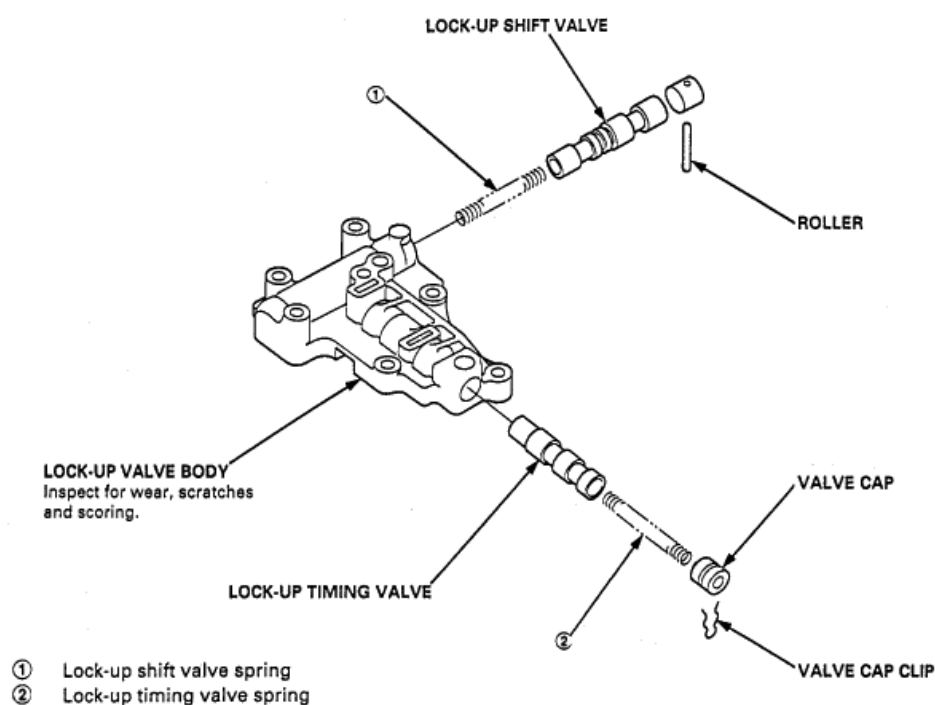

BMXA, SLXA LOCKUP

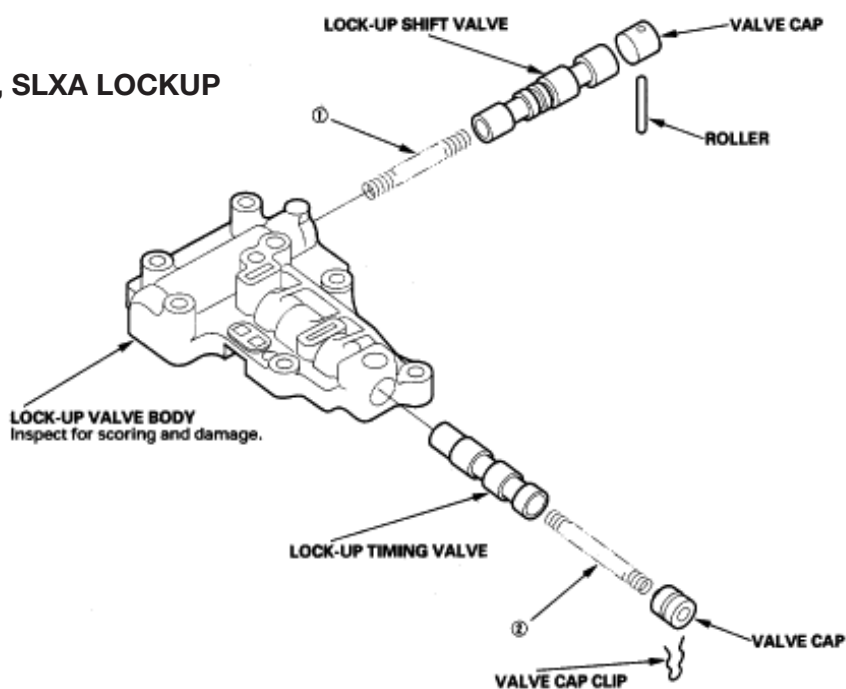

SPRING SPECIFICATIONS

No.	Spring	Standard (New)-Unit: mm (in.)			
		Wire Dia.	O.D.	Free Length	No. of Coils
①	Lock-up shift valve spring	0.9 (0.035)	7.6 (0.299)	73.7 (2.902)	32.0
②	Lock-up timing valve spring	0.9 (0.035)	8.1 (0.319)	80.7 (3.177)	54.2

S24A LOCKUP

